

PLAN
SCALE: 1" = 20'

**STANDARD NOTES FOR DEVELOPMENT
SANITARY SEWER PROJECTS**

- HAMILTON COUNTY WATER & WASTEWATER TREATMENT AUTHORITY (WWT) STANDARD SPECIFICATIONS APPLY WPL-98-0389
- CONSTRUCT PROPERTY SERVICE CONNECTION TO EDGE OF EASEMENT OR TO EDGE OF RIGHT-OF-WAY AS DIRECTED.
- ALL PIPE TO BE PVC WPC-98-0389
- PROPERTY SERVICE CONNECTIONS MUST BE A MIN. 1.0% SLOPE UNLESS OTHERWISE NOTED
- ROCK TO BE SHATTERED TO 6- FEET BEYOND END OF PROPERTY SERVICE CONNECTIONS.
- VERTICAL DATUM IS REFERENCED TO NATIONAL GEODETIC VERTICAL DATUM (1929), (OTHERWISE NOTED)
- LOT CORNERS, AS SHOWN, WILL BE STAKED WHEN THE RECORD PLAT IS RECORDED (OTHERWISE NOTED)
- SEWAGE FROM THIS DEVELOPMENT WILL BE TREATED AT THE LOCAL SEWAGE TREATMENT PLANT.
- WWT SHALL INSPECT ALL SEWER CONSTRUCTION. CONTRACTOR TO OBTAIN TWP. OR PERMIT FROM WWT AND CONTACT WWT 24 HOURS BEFORE CONSTRUCTION BEGINS.

**WWTA STANDARD
DETAIL REFERENCES**

TYPICAL TRENCH AND BEDDING FOR - SD-13
PVC GRAVITY PIPE
STANDARD INVERT DIMENSIONS - SD-3
STANDARD DROP MANHOLE - SD-5

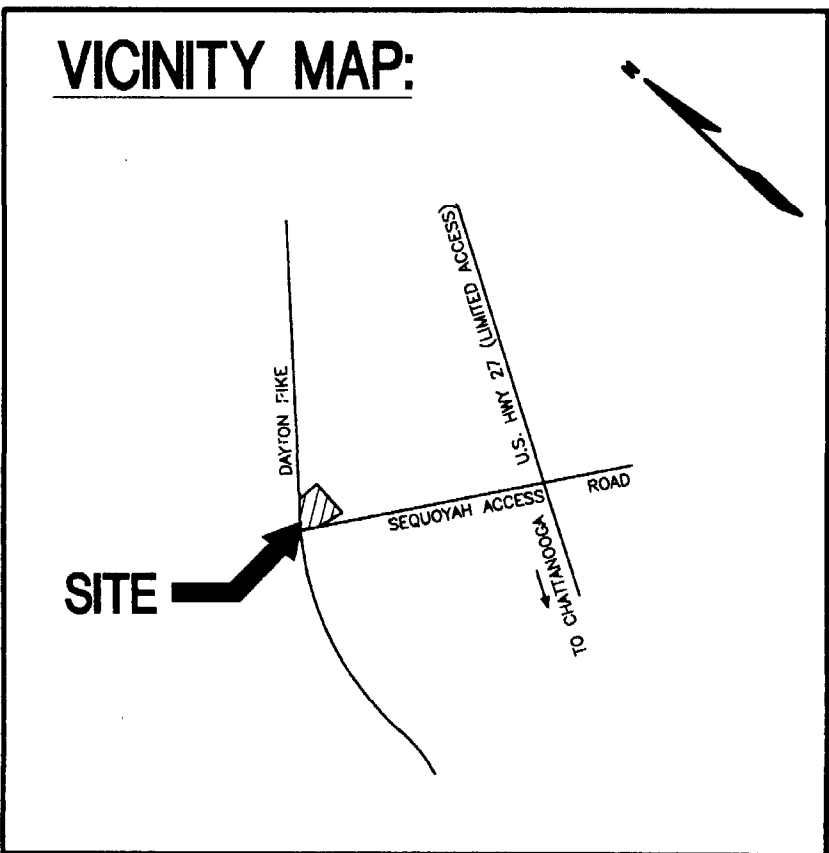

- GENERAL NOTES:**
- THE INFORMATION SHOWN HEREIN WAS TAKEN FROM TOPOGRAPHIC SURVEY PERFORMED BY: ALLEN SURVEYING COMPANY, 2228 DAYTON BLVD., SUITE "M", CHATTANOOGA, TN 37415, TEL: 423-875-0198; FAX: 423-877-8747
 - THE LOCATIONS OF ALL UTILITIES SHOWN ON THESE PLANS ARE BASED ON THE AVAILABLE INFORMATION. THE CONTRACTOR SHALL VERIFY THE EXACT LOCATION OF UTILITIES PRIOR TO ANY CONSTRUCTION.
 - ANY DISCREPANCY IN THIS PLAN AND ACTUAL FIELD CONDITIONS SHALL BE REPORTED TO THE OWNER PRIOR TO START OF CONSTRUCTION. GENERAL CONTRACTOR SHALL BE RESPONSIBLE FOR VERIFICATION OF ALL SETBACKS, EASEMENTS, AND DIMENSIONS SHOWN HEREON BEFORE CONSTRUCTION.
 - PRIOR TO STARTING CONSTRUCTION, THE GENERAL CONTRACTOR SHALL BE RESPONSIBLE TO VERIFY THAT ALL EASEMENTS, UTILITIES AND R.O.W.'S, PUBLIC OR PRIVATE, PRIOR TO WORKING IN THESE AREAS. FAILURE OF THE CONTRACTOR TO FOLLOW THIS PROCEDURE SHALL CAUSE THE CONTRACTOR TO ASSUME FULL RESPONSIBILITY FOR ANY SUBSEQUENT MODIFICATION OF THE WORK MANDATED BY ANY REGULATORY AUTHORITY.
 - THE GENERAL CONTRACTOR SHALL CONTACT ALL OWNERS OF EASEMENTS, UTILITIES AND R.O.W.'S, PUBLIC OR PRIVATE, PRIOR TO WORKING IN THESE AREAS.
 - CONTRACTOR SHALL MAINTAIN THE SITE IN A MANNER SO THAT WORKMEN AND PUBLIC SHALL BE PROTECTED FROM INJURY, AND ADJOINING PROPERTY PROTECTED FROM DAMAGE.
 - ACCESS TO UTILITIES, FIRE HYDRANTS, STREET LIGHTING, ETC., SHALL REMAIN UNDISTURBED, UNLESS COORDINATED WITH RESPECTIVE UTILITY.
 - CONTRACTOR IS RESPONSIBLE FOR DAMAGE TO ANY EXISTING ITEM AND/OR MATERIAL INSIDE OR OUTSIDE CONTRACT LIMITS DUE TO CONSTRUCTION OPERATIONS.
 - THE GENERAL CONTRACTOR SHALL REMOVE ALL TRASH AND DEBRIS FROM THE SITE UPON COMPLETION OF THE PROJECT AND AT LEAST ONCE A WEEK DURING CONSTRUCTION.
 - THE G.C. SHALL KEEP THE AREA OUTSIDE THE "CONSTRUCTION LIMITS" BROOM CLEAN AT ALL TIMES.
 - ALL ROAD WORK SHALL BE PERFORMED IN ACCORDANCE WITH THE CURRENT EDITION OF THE STATE OF KENTUCKY, DEPARTMENT OF TRANSPORTATION "CONSTRUCTION AND MATERIAL SPECIFICATIONS".
 - ALL DISTURBED AREAS SHALL HAVE TEMPORARY SEEDING AND MULCHING. ALL AREAS THAT ARE PLANNED TO BE BARE FOR MORE THAN 45 DAYS SHALL BE SEED AND MULCHED WITHIN SEVEN(7) DAYS.
 - ALL STREET SURFACES, DRIVEWAYS, CULVERTS, CURB AND GUTTERS, ROADSIDE DRAINAGE DITCHES AND OTHER STRUCTURES THAT ARE DISTURBED OR DAMAGED IN ANY MANNER AS A RESULT OF CONSTRUCTION SHALL BE REPLACED OR REPAIRED IN ACCORDANCE WITH THE SPECIFICATIONS.

NOTE: CAUTION EXISTING UTILITIES
THE INFORMATION SHOWN ON THESE DRAWINGS CONCERNING TYPE AND LOCATION OF UNDERGROUND UTILITIES IS NOT GUARANTEED TO BE ACCURATE OR ALL INCLUSIVE. LOCATION, SIZE, AND MATERIAL SHOWN ON UTILITIES ARE FROM AVAILABLE RECORDS, SUPPLIED BY THE RESPECTIVE UTILITY COMPANY. TENN. UNDERGROUND MUST BE NOTIFIED 24 HOURS TO ANY EXCAVATION FOR VERIFICATION OF LOCATION, SIZE AND MATERIAL.

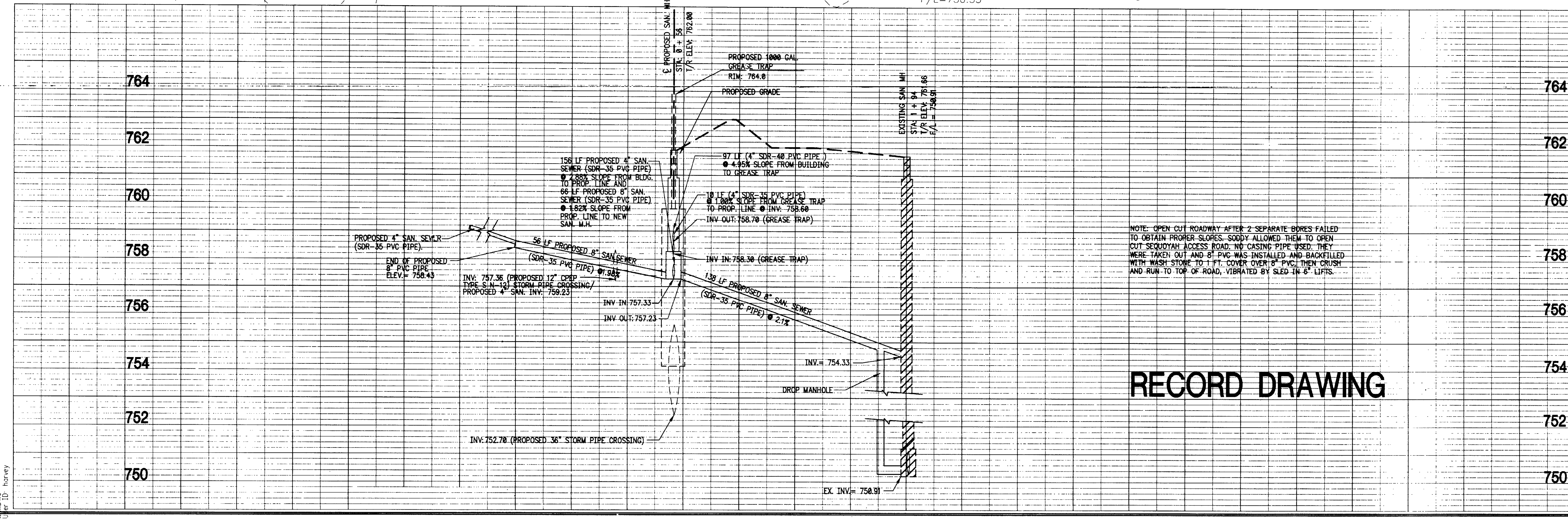

RECORD DRAWING

LEGEND

	EX. STORM SEWER (W/SIZE)
	CATCH BASIN
	PROPOSED SANITARY SEWER
	EXISTING SANITARY SEWER
	EXISTING WATER LINE
	EXISTING GAS LINE
	IRON PIN (W/ PROPERTY LINE)
	LIGHT POLE
	POWER POLE
	EXIST. UNDERGROUND UTILITY
	EXIST. OVERHEAD UTILITY
	TEMPORARY BENCH MARK
	PROPERTY SERVICE CONNECTION (SEE STANDARD NOTES)

PROFILE
SCALE: 1" = 20' HORIZONTAL
1" = 2' VERTICAL

SANITARY SEWER EXTENTION
SCALE: 1" = 20'-0"

REVISIONS:

JOB NO.: **98187**

BURGER KING RESTAURANT
10180 DAYTON PIKE
SODDY DAISY, TN

THE ROBERTS GROUP, PSC
235 Southman Drive
Suite C
Chattanooga, TN 37415
423-875-0198

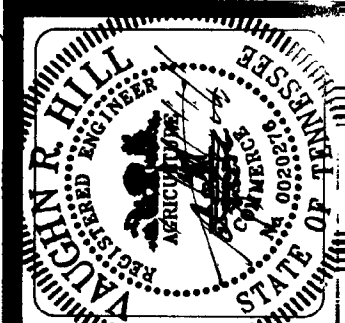

THESE PLANS AND THE INFORMATION HEREIN ARE THE PROPERTY OF AMERICAN BURGER KING AND SHALL NOT BE USED, REPRODUCED, COPIED, CHANGED, OR IN ANY MANNER TRANSMITTED WITHOUT THE EXPRESS WRITTEN PERMISSION OF AMERICAN BURGER KING.

DATE: 06/15/98

DRAWN BY: TRG

CHECKED BY: TRG



SAN. SEWER EXTENTION PLAN

SHEET NO.
C-3A